



REZIDE  
GROUP



ASKING PRICE £190,000

LOUGHBOROUGH ROAD, MOUNTSORREL, LOUGHBOROUGH



Welcome to your charming retreat on Loughborough Road in the heart of Mountsorrel. This inviting three-bedroom terrace property offers an idyllic blend of comfort and character, boasting two reception rooms, a spacious garden, and a detached garage.



As you step through the quaint porch, you're greeted by the bright and airy lounge, featuring a captivating fireplace with an oak surround. Laminated flooring adds a touch of elegance while the chandelier-style light fitting illuminates the space. Passing through, you'll find a convenient storage cupboard before entering the dining room, another inviting space adorned with a roaring log burner, soft carpets, and a view of the rear courtyard.

The well-equipped galley kitchen awaits next, offering ample work surface and cupboard space behind stylish white shaker-style doors. Tiled flooring adds practicality, and integrated appliances including a gas hob, electric oven, fridge, and freezer ensure modern convenience.







Completing the ground floor is the bathroom, featuring a three-piece suite including a bath, shower, and pedestal basin. Tiled floors and an obscured glass window add to the functionality and privacy of this space, with convenient access to the separate WC toilet.

Venturing upstairs, you'll find three bedrooms, each offering its own unique charm. Bedroom one impresses with its spaciousness, featuring characterful high ceilings, and an inbuilt cupboard over the stairs. Bedroom two offers a tranquil view of the garden, while bedroom three presents versatility, ideal for





various uses including a study or dressing room.

Outside, a small quaint front garden welcomes you, while to the rear, a spacious garden awaits, hidden behind the single garage and parking spaces for the property. With Mountsorrel's thriving village atmosphere and promising future prospects, this property presents an exceptional opportunity for comfortable living and wise investment. Don't miss out on making Mountsorrel your home in 2024!



GROUND FLOOR  
416 sq.ft. (38.6 sq.m.) approx.

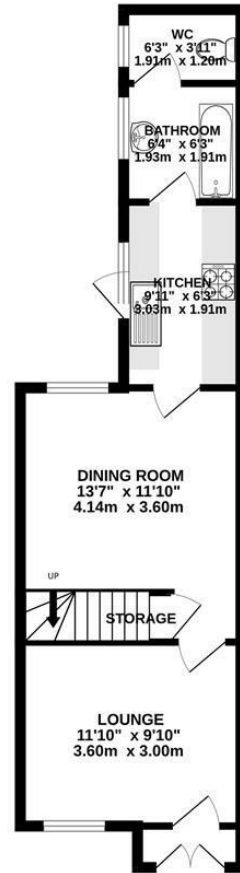

1ST FLOOR  
339 sq.ft. (31.5 sq.m.) approx.



REZIDE  
GROUP

TOTAL FLOOR AREA: 755 sq.ft. (70.1 sq.m.) approx.

Whilst every attempt has been made to ensure the accuracy of the floorplan contained here, measurements of doors, windows, rooms and any other items are approximate and no responsibility is taken for any error, omission or mis-statement. This plan is for illustrative purposes only and should be used as such by any prospective purchaser. The services, systems and appliances shown have not been tested and no guarantee as to their operability or efficiency can be given.

Made with Metropix ©2024

